



**FALL 2024**

COURSE  
SCHEDULES



Call or text **Clovis Community College** at **575.479.5006** or email **recruitment@clovis.edu** to set up your personalized journey today.

### **STEP 1: APPLY FOR ADMISSION**

Visit **clovis.edu/apply** to apply online or fill out an application on campus. Send all official transcripts to **admissions@clovis.edu**.

### **STEP 2: COMPLETE FINANCIAL AID**

Go to **studentaid.gov** to complete the Free Application for Federal Student Aid (FAFSA). For more information on financial aid or scholarships, call **575.769.4060** or email **finaid@clovis.edu**.

### **STEP 3: CONNECT WITH CAREER SERVICES**

Unsure of what to study? Meet with the Career Services Coordinator to complete the Career Interest Inventory. Call **575.769.4085** or email **career.services@clovis.edu** to schedule an appointment.

### **STEP 4: MEET WITH YOUR ADVISOR**

Advisors can help interpret placement scores, evaluate transcripts from other schools and assist in selecting classes for the upcoming semester. Call **575.769.4020** or email **academic.advising@clovis.edu** to schedule an appointment.

### **STEP 5: MAKE PAYMENT ARRANGEMENTS**

For more information regarding payment, please contact the Business Office at **575.769.4035** or visit **clovis.edu/payment**.

### **STEP 6: GET YOUR STUDENT ID**

Say cheese! Once payment arrangements have been made, obtain a student ID card by visiting Campus Security. Your student ID is needed at the library, gym, computer labs, and more!

## IMPORTANT DATES

Fall Registration begins  
April 8, 2024.

Senior Citizen registration begins on  
April 9 and ends on the last day of  
registration for the term listed below.

Classes start August 19.

Extended Hours Registration: August 6, 8,  
and 14. Open Until 7:00 PM.

Super Saturday Registration: August 10,  
10:00 AM to 3:00 PM.

### Classes Begin/End

Regular 16-week term . . . . . August 19 - December 6  
First 8-week term . . . . . August 19 - October 11  
Second 8-week term . . . . . October 14 - December 6

### Last day to register, add, or drop a class or change from audit to credit

Regular 16-week term . . . . . August 23  
First 8-week term . . . . . August 23  
Second 8-week term . . . . . October 18

### Last day to change from credit to audit

Regular 16-week term . . . . . October 11  
First 8-week term . . . . . September 13  
Second 8-week term . . . . . November 11

### Last day to withdraw from a class

Regular 16-week term . . . . . November 11  
First 8-week term . . . . . September 27  
Second 8-week term . . . . . November 25  
(Workshops: before the first meeting)

## Finals Week:

You may have a different class meeting time during Finals  
Week. Please check your course syllabus for details.

## Holiday Closures (Campus Closed)

Labor Day. . . . . September 2  
Veteran's Day . . . . . November 11  
Thanksgiving Holiday . . . November 27 - December 1  
Winter Break . . . . . December 20 - January 3

## Ceremony

PTA Pinning Ceremony . . . . . December 5  
Nurses' Pinning Ceremony . . . . . December 5

## Graduation Application Deadline

Fall 2024 Diploma/Certificate. . . . . October 18

## Refund Schedule

Full refund of tuition and fees will be issued on canceled  
classes. Refunds are processed after registration closes  
and financial aid is complete and will be mailed to students  
approximately four weeks after registration closes.  
If you have any questions, contact the Business Affairs Office  
at [575.769.4132](tel:575.769.4132) or see [www.clovis.edu/fees](http://www.clovis.edu/fees).

Students who drop a workshop must notify the Business  
Affairs Office to begin the refund process.

## Regular 16-Week Term

August 19 - 30 . . . . . 100% refund  
August 31 - December 6 . . . . . 0% refund

## First 8-Week Term

August 19 - 23 . . . . . 100% refund  
August 24 - October 11 . . . . . 0% refund

## Second 8-Week Term

October 12 - 18 . . . . . 100% refund  
October 19 - December 6 . . . . . 0% refund

## Textbook Affordability Package (TAP)

**Opt Out information.** Deadline to opt out for fall  
is August 23 for 1st 8-week classes, August 30 for  
16-week classes, and October 18 for 2nd 8-week  
classes.

## Workshops

Before the first meeting . . . . . 100% refund

## Final Exams

Regular 16-week term . . . . . December 2 - 6  
First 8-week term . . . . . October 7 - 11  
Second 8-week term . . . . . December 2 - 6

This class schedule is subject to change after publication. Please check for changes with the Academic Advising Office or the CCC website for the most up-to-date course information. Consumer information for Clovis Community College, including our graduation rates, the median debt of students completing programs, and other important information, can be found at: [clovis.edu/consumerinfo](http://clovis.edu/consumerinfo).



# CLOVIS COMMUNITY COLLEGE COURSE MODELS AT-A-GLANCE

## WHERE



BRICK-AND-MORTAR



VIRTUAL LEARNING ENVIRONMENT

## WHEN



AT A SCHEDULED TIME



AT STUDENT'S OWN TIME  
Assignment deadlines determined by instructor

## HOW



ON-SITE CLASSROOM TECHNOLOGY



MOBILE TECHNOLOGY

## Clovis Community College

Course Modes Info-graphic Text Description.

### WHERE

1. On Campus - At Clovis Community College
2. Online - Virtual Learning Environment

### WHEN

1. Live - At a designated, scheduled time
2. Online - At the student's own time

### HOW

1. On-site Classroom Technology
2. Mobile Technology (home computer, mobile phone, laptop)

## Course Model Descriptions

### On Campus

- Where: All class time spent on CCC campus
- When: Live, at a designated, scheduled time
- How: Using on-site classroom technology

### Live Online

- Where: All class time spent in a virtual learning environment
- When: Live, at a designated, scheduled time
- How: Using mobile technology

### Fully Online

- Where: All class time spent in a virtual learning environment
- When: Online, at the student's own time (assignment deadlines specified by instructor)
- How: Using mobile technology

### Hybrid

- Where: Portion of the course is spent on campus, and portion is spent online in a virtual learning environment
- When: Class time occurs with a mix of designated, scheduled time and work at the student's own time
- How: Using both on-site classroom and mobile technology

### Mixed

Instructor defines the mode; Student decides how to participate

- On Campus - At a designated, scheduled time
- Live Online - At a designated, scheduled time
- Fully Online - completed on the student's own time (assignment deadlines specified by instructor)

## ON CAMPUS



## LIVE ONLINE



## FULLY ONLINE



## HYBRID | Both Required

### ON CAMPUS



### ONLINE



## MIXED | Student decides based on modes defined by instructor

### ON CAMPUS



OR

### LIVE ONLINE



OR

### FULLY ONLINE



## Accounting

CRN	SUBJ	NUM	SEC	HRS	TITLE	DAYS	TIME	INSTRUCTOR	FEES	COURSE MODE OPTIONS			
										ON CAMPUS	LIVE ONLINE	ONLINE	HYBRID
32262	ACCT	2110	301	4	Principles of Accounting I	MW	12:00 pm-1:40 pm	Turner, Monica		x			
32263	ACCT	2110	3N0	4	Principles of Accounting I		ONLINE	Turner, Monica	\$50			x	
32264	ACCT	2120	301	4	Principles of Accounting II	W	5:00 pm-8:15 pm	Turner, Monica		x			
32417	ACCT	2220	3N0	3	Computerized Accounting		ONLINE	Turner, Monica	\$50			x	

## Agricultural Science

CRN	SUBJ	NUM	SEC	HRS	TITLE	DAYS	TIME	INSTRUCTOR	FEES	COURSE MODE OPTIONS			
										ON CAMPUS	LIVE ONLINE	ONLINE	HYBRID
32621	AGRO	1110C	3N0	4	Intro to Plant Science/Lab		ONLINE	TBD	\$50			x	

## Animal Science

CRN	SUBJ	NUM	SEC	HRS	TITLE	DAYS	TIME	INSTRUCTOR	FEES	COURSE MODE OPTIONS			
										ON CAMPUS	LIVE ONLINE	ONLINE	HYBRID
32581	ANSC	1120C	3N0	4	Intro to Animal Science/Lab		ONLINE	TBD	\$50			x	

## Anthropology

CRN	SUBJ	NUM	SEC	HRS	TITLE	DAYS	TIME	INSTRUCTOR	FEES	COURSE MODE OPTIONS			
										ON CAMPUS	LIVE ONLINE	ONLINE	HYBRID
31991	ANTH	1140	3N0	3	Intro to Cultural Anthropology		ONLINE	Schipani, Alexandra	\$50			x	
32265	ANTH	1180	3N0	3	The Dawn of Humanity		ONLINE	Schipani, Alexandra	\$50			x	

## Art History

CRN	SUBJ	NUM	SEC	HRS	TITLE	DAYS	TIME	INSTRUCTOR	FEES	COURSE MODE OPTIONS			
										ON CAMPUS	LIVE ONLINE	ONLINE	HYBRID
31996	ARTH	1110	301	3	Art Appreciation	TR	10:30 am-11:45 am	Wright, William		x			
31998	ARTH	1110	3N0	3	Art Appreciation		ONLINE	Anderson, Marsha	\$50			x	
32762	ARTH	2110	3N0	3	History of Art I		ONLINE	Longhofer, Michael	\$50			x	

## Art Studio

CRN	SUBJ	NUM	SEC	HRS	TITLE	DAYS	TIME	INSTRUCTOR	FEES	COURSE MODE OPTIONS			
										ON CAMPUS	LIVE ONLINE	ONLINE	HYBRID
31995	ARTS	1250	301	3	Design II	W	1:30 pm-4:00 pm	Longhofer, Michael		x			
32005	ARTS	1340	301	3	Functional Ceramics I	T	3:00 pm-5:30 pm	Wright, William	\$30	x			
32527	ARTS	1520	3L0	3	Digital Media I	TR	1:30 pm-2:45 pm	Hurlebusch, Judith	\$50		x		
32822	ARTS	1530	3N0	3	Digital Media II		ONLINE	Hurlebusch, Judith	\$50			x	
31992	ARTS	1610	301	3	Drawing I	MW	10:30 am-11:45 am	Longhofer, Michael		x			
31999	ARTS	1620	301	3	Life Drawing I	T	1:30 pm-4:00 pm	Longhofer, Michael		x			
32648	ARTS	2120	3L0	3	Graphic Design I	MW	1:30 pm-2:45 pm	Hurlebusch, Judith	\$50		x		
32788	ARTS	2630	101	3	Painting II	R	9:00 am-11:30 am	Longhofer, Michael		x			

## Automotive Technology

CRN	SUBJ	NUM	SEC	HRS	TITLE	DAYS	TIME	INSTRUCTOR	FEES	COURSE MODE OPTIONS			
										ON CAMPUS	LIVE ONLINE	ONLINE	HYBRID
<b>30390</b>	AT	100	301	4	Intro to Auto Electronics	MW	2:00 pm-3:40 pm	Blair, Paul	\$50	x			

Other than the Automotive class listed above the full-time Automotive Technology program runs Monday - Thursday from 7 a.m. to 12:15 p.m. To apply students should call 575.769.4945 or stop by Room 403. Students must complete AT 100 with a C or better, complete an OT application, and meet the Accuplacer score requirements prior to being accepted into the program. Applications are now being accepted for Fall 2024 and Spring 2025.

## Biology

CRN	SUBJ	NUM	SEC	HRS	TITLE	DAYS	TIME	INSTRUCTOR	FEES	COURSE MODE OPTIONS			
										ON CAMPUS	LIVE ONLINE	ONLINE	HYBRID
<b>32023</b>	BIOL	1110C	3N0	4	General Biology Lecture/Lab		ONLINE	Sloan, Nancy	\$50				x
<b>32024</b>	BIOL	1130C	3N0	4	Intro Anat/Phys Lec/Lab NonMaj		ONLINE	Hughes, Michelle	\$50				x
<b>32577</b>	BIOL	2110C	301	4	Prin of Bio: Cell/Molecular	MW	9:00 am-11:30 am	Kuykendall, Todd	\$20	x			
<b>32025</b>	BIOL	2210C	301	4	Human Anat/Phys I Lec/Lab	MW	9:00 am-11:30 am	Sparks, Christopher	\$20	x			
<b>32026</b>	BIOL	2210C	302	4	Human Anat/Phys I Lec/Lab	TR	12:00 pm-2:30 pm	TBD	\$20	x			
<b>32425</b>	BIOL	2210C	303	4	Human Anat/Phys I Lec/Lab	MW	6:00 pm-8:30 pm	TBD	\$20	x			
<b>32028</b>	BIOL	2210C	304	4	Human Anat/Phys I Lec/Lab	TR	9:00 am-11:30 am	Sparks, Christopher	\$20	x			
<b>32032</b>	BIOL	2210C	3N0	4	Human Anat/Phys I Lec/Lab		ONLINE	Sparks, Christopher	\$50				x
<b>32034</b>	BIOL	2225C	301	4	Human Anat/Phys II Lec/Lab	TR	12:00 pm-2:30 pm	TBD	\$20	x			
<b>32035</b>	BIOL	2225C	302	4	Human Anat/Phys II Lec/Lab	TR	6:00 pm-8:30 pm	Minteer, Allison	\$20	x			
<b>32036</b>	BIOL	2225C	3N0	4	Human Anat/Phys II Lec/Lab		ONLINE	Minteer, Allison	\$50				x
<b>32037</b>	BIOL	2310C	301	4	Microbiology Lecture/Lab	TR	6:00 pm-8:30 pm	TBD	\$20	x			
<b>32038</b>	BIOL	2310C	302	4	Microbiology Lecture/Lab	TR	9:00 am-11:30 am	Hughes, Michelle	\$20	x			
<b>32039</b>	BIOL	2310C	303	4	Microbiology Lecture/Lab	MW	12:00 pm-2:30 pm	Hughes, Michelle	\$20	x			
<b>32040</b>	BIOL	2310C	3N0	4	Microbiology Lecture/Lab		ONLINE	Hughes, Michelle	\$50				x

## Business Administration

CRN	SUBJ	NUM	SEC	HRS	TITLE	DAYS	TIME	INSTRUCTOR	FEES	COURSE MODE OPTIONS			
										ON CAMPUS	LIVE ONLINE	ONLINE	HYBRID
<b>32269</b>	BUSA	1110	301	3	Introduction to Business	TR	10:30 am-11:45 am	Reed, Melissa		x			
<b>32270</b>	BUSA	1110	3N0	3	Introduction to Business		ONLINE	Reed, Melissa	\$50				x
<b>32427</b>	BUSA	2110	3N0	3	Business Communications		ONLINE	Schmidt, Michelle	\$50				x

## Business Computer Information Systems

CRN	SUBJ	NUM	SEC	HRS	TITLE	DAYS	TIME	INSTRUCTOR	FEES	COURSE MODE OPTIONS			
										ON CAMPUS	LIVE ONLINE	ONLINE	HYBRID
<b>32274</b>	BCIS	1110	301	3	Fund of Info Literacy/Systems	W	6:00 pm-8:30 pm	Byers, Diana		x			
<b>32795</b>	BCIS	1110	302	3	Fund of Info Literacy/Systems	MW	10:30 am-11:45 am	Byers, Diana		x			
<b>32275</b>	BCIS	1110	3N0	3	Fund of Info Literacy/Systems		ONLINE	Byers, Diana	\$50				x

*BCIS 1110 covers the Microsoft Office 365 Windows versions of Word, Excel, Access, and PowerPoint.*

## Business Law

CRN	SUBJ	NUM	SEC	HRS	TITLE	DAYS	TIME	INSTRUCTOR	FEES	COURSE MODE OPTIONS			
										ON CAMPUS	LIVE ONLINE	ONLINE	HYBRID
<b>32272</b>	BLAW	2110	3N0	3	Business Law I		ONLINE	Talbert, Laura	\$50				x

## Chemistry

CRN	SUBJ	NUM	SEC	HRS	TITLE	DAYS	TIME	INSTRUCTOR	FEES	COURSE MODE OPTIONS			
										ON CAMPUS	LIVE ONLINE	ONLINE	HYBRID
<b>32796</b>	CHEM	1120C	301	4	Intro to Chem Lec/Lab Non-Maj	TR	9:00 am-11:30 am	TBD		x			
<b>32043</b>	CHEM	1120C	3N0	4	Intro to Chem Lec/Lab Non-Maj		ONLINE	TBD	\$50			x	
<b>32797</b>	CHEM	1215C	301	4	Gen Chem I Lec/Lab for STEM	MW	12:00 pm-2:30 pm	TBD		x			
<b>32045</b>	CHEM	1215C	3N0	4	Gen Chem I Lec/Lab for STEM		ONLINE	TBD	\$50			x	

## Communication

CRN	SUBJ	NUM	SEC	HRS	TITLE	DAYS	TIME	INSTRUCTOR	FEES	COURSE MODE OPTIONS			
										ON CAMPUS	LIVE ONLINE	ONLINE	HYBRID
<b>32452</b>	COMM	1130	301	3	Public Speaking	MW	9:00 am-10:15 am	Knight, Kelsey		x			
<b>32686</b>	COMM	1130	302	3	Public Speaking	TR	10:30 am-11:45 am	Thomas, Celeste		x			
<b>32068</b>	COMM	1130	3N0	3	Public Speaking		ONLINE	Thomas, Celeste	\$50			x	
<b>32046</b>	COMM	2120	301	3	Interpersonal Communication	MW	10:30 am-11:45 am	Thomas, Celeste		x			
<b>32047</b>	COMM	2120	302	3	Interpersonal Communication	TR	9:00 am-10:15 am	Knight, Kelsey		x			
<b>32798</b>	COMM	2120	3B0	3	Interpersonal Communication	T	6:00 pm-8:30 pm	Knight, Kelsey	\$25				x
<b>32050</b>	COMM	2120	3N0	3	Interpersonal Communication		ONLINE	Knight, Kelsey	\$50			x	

## Computer Information Systems

CRN	SUBJ	NUM	SEC	HRS	TITLE	DAYS	TIME	INSTRUCTOR	FEES	COURSE MODE OPTIONS			
										ON CAMPUS	LIVE ONLINE	ONLINE	HYBRID
<b>30085</b>	CIS	101	3N0	3	Fund of Computer Concepts		ONLINE	Byers, Diana	\$50			x	
<b>32658</b>	CIS	102	301	4	Networking Concepts	T	6:00 pm-9:15 pm	Walker, Raymond	\$30	x			
<b>30836</b>	CIS	125	3N0	3	Intro to Programming Concepts		ONLINE	TBD	\$50			x	
<b>31791</b>	CIS	134	301	4	Computer Hardware / Software	R	6:00 pm-9:15 pm	Walker, Raymond	\$30	x			
<b>32730</b>	CIS	135	3N0	4	Network Fund for Network+		ONLINE	TBD	\$50			x	
<b>31908</b>	CIS	140	3N0	3	Intro to Word Processing		ONLINE	Byers, Diana	\$50			x	
<i>*CIS 140 will be taught using the Microsoft Office 2019/Office 365 Windows versions of Word</i>													
<b>30096</b>	CIS	150	3N0	3	Introduction to Spreadsheets		ONLINE	Byers, Diana	\$50			x	
<i>*CIS 150 will be taught using the Microsoft Office 2019/Office 365 Windows versions of Excel</i>													
<b>32731</b>	CIS	203	301	4	Configuring Enterprise Service	W	6:00 pm-9:15 pm	Walker, Raymond	\$30	x			
<b>31394</b>	CIS	232	3N0	4	Serv Admin Use Micro Win Serv		ONLINE	Walker, Raymond	\$50			x	
<b>32537</b>	CIS	235	3N0	3	Fund of Network Security		ONLINE	TBD	\$50			x	
<b>32660</b>	CIS	240	3N0	4	Network Hacking Countermeasure		ONLINE	Davis, Jesse	\$50			x	

## Cosmetology

The Cosmetology program runs Monday - Thursday from 8 a.m. to 5 p.m. To apply students should call 575.769.4945 or stop by Room 403. Students will need to fill out a Cosmetology application, submit high school transcripts to the Office of Admissions, and meet the Accuplacer score requirements prior to being accepted into the program. Applications are now being accepted for Fall 2024 and Spring 2025.

## Criminal Justice

CRN	SUBJ	NUM	SEC	HRS	TITLE	DAYS	TIME	INSTRUCTOR	FEES	COURSE MODE OPTIONS			
										ON CAMPUS	LIVE ONLINE	ONLINE	HYBRID
<a href="#">32069</a>	CJUS	1110	3N0	3	Intro to Criminal Justice		ONLINE	Gallegos, Mark	\$50			X	
<a href="#">32072</a>	CJUS	1120	3N0	3	Criminal Law		ONLINE	Gallegos, Mark	\$50			X	
<a href="#">32074</a>	CJUS	1140	3N0	3	Juvenile Justice		ONLINE	Gallegos, Mark	\$50			X	
<a href="#">32799</a>	CJUS	2130	3N0	3	Police and Society		ONLINE	Salazar, Freddie	\$50			X	
<a href="#">32071</a>	CJUS	2140	3N0	3	Criminal Investigations		ONLINE	Salazar, Freddie	\$50			X	
<a href="#">32073</a>	CJUS	2340	3N0	3	Victimization in Amer Society		ONLINE	Salazar, Freddie	\$50			X	

## Dance

CRN	SUBJ	NUM	SEC	HRS	TITLE	DAYS	TIME	INSTRUCTOR	FEES	COURSE MODE OPTIONS			
										ON CAMPUS	LIVE ONLINE	ONLINE	HYBRID
<a href="#">32076</a>	DANC	1110	3N0	3	Dance Appreciation		ONLINE	Heath, Bradley	\$50			X	

## Early Childhood Education

CRN	SUBJ	NUM	SEC	HRS	TITLE	DAYS	TIME	INSTRUCTOR	FEES	COURSE MODE OPTIONS			
										ON CAMPUS	LIVE ONLINE	ONLINE	HYBRID
<a href="#">32077</a>	ECED	1110	3N0	3	Child Growth, Dev & Learning		ONLINE	Martin, Cindy	\$50			X	
<a href="#">32080</a>	ECED	1115	3N0	2	Health, Safety, & Nutrition		ONLINE	Coburn, Michelle	\$50			X	
<a href="#">32087</a>	ECED	1120	3N0	3	Guiding Young Children		ONLINE	Coburn, Michelle	\$50			X	
<a href="#">32088</a>	ECED	1125	3N0	3	Assessment Child/Eval Program		ONLINE	TBD	\$50			X	
<a href="#">32086</a>	ECED	1130	3N0	3	Family & Comm Collaboration		ONLINE	Boreing, Karen	\$50			X	
<a href="#">32823</a>	ECED	2110	3N0	2	Professionalism		ONLINE	Thornton, Linda	\$50			X	
<a href="#">32800</a>	ECED	2115	3Z0	3	Intro to Lang, Literacy & Read	R	6:00 pm-8:30 pm	Boreing, Karen	\$25	X	X		
<a href="#">32801</a>	ECED	2120	3Z0	3	Curr Dev Play Birth to Age 4	W	6:45 pm-9:15 pm	Martin, Cindy	\$25	X	X	X	
<a href="#">32802</a>	ECED	2121	3Z0	2	Curr Dev Play Birth Age 4 Prac	W	5:00 pm-6:44 pm	Martin, Cindy	\$25	X	X	X	

## Economics

CRN	SUBJ	NUM	SEC	HRS	TITLE	DAYS	TIME	INSTRUCTOR	FEES	COURSE MODE OPTIONS			
										ON CAMPUS	LIVE ONLINE	ONLINE	HYBRID
<a href="#">32091</a>	ECON	2110	3N0	3	Macroeconomic Principles		ONLINE	Kuykendall, Robin	\$50			X	
<a href="#">32093</a>	ECON	2120	3N0	3	Microeconomic Principles		ONLINE	Kuykendall, Robin	\$50			X	

## Electrical Maintenance

The Electrical Maintenance program is part of the Industrial Technology program and trains students in fundamentals of electricity, control systems, planning, design, and power generation and prepares students for jobs that rely on integrated systems. This program is two semesters and runs Tuesdays & Thursdays from 5:30 to 9:15 p.m. To apply students should call 575.769.4945 or stop by Room 403. Students will need to fill out an OT application and meet the Accuplacer score requirements prior to being accepted into the program. Applications are now being accepted for Fall 2024 and Fall 2025.



## Emergency Medical Services

CRN	SUBJ	NUM	SEC	HRS	TITLE	DAYS	TIME	INSTRUCTOR	FEES	COURSE MODE OPTIONS			
										ON CAMPUS	LIVE ONLINE	ONLINE	HYBRID
32410	EMS	115	3N0	4	Anat/Phys for EMS Professional		ONLINE	Burns, Karen	\$50			x	
31149	EMS	120	3B0	8	Emer Medical Technician-Basic	MTR	6:00 pm-9:30 pm	Burns, Karen	\$499				x
31423	EMS	120L	301	3	EMT / Basic Lab	MTR	6:00 pm-9:30 pm	Burns, Karen	\$65	x			
30141	EMS	122	3B0	4	Emer Med Tech-Intermediate	TWR	5:00 pm-9:30 pm	Burns, Karen	\$650				x
32094	EMS	122L	301	2	Emer Med Tech-Interme Lab	TWR	5:00 pm-8:30 pm	Burns, Karen	\$65	x			

## English

CRN	SUBJ	NUM	SEC	HRS	TITLE	DAYS	TIME	INSTRUCTOR	FEES	COURSE MODE OPTIONS			
										ON CAMPUS	LIVE ONLINE	ONLINE	HYBRID
32095	ENGL	1110	301	3	Composition I	M	6:00 pm-8:30 pm	Brown, Shauma		x			
32097	ENGL	1110	302	3	Composition I	MW	1:30 pm-2:45 pm	Brown, Shauma		x			
32098	ENGL	1110	303	3	Composition I	TR	9:00 am-10:15 am	Brown, Shauma		x			
32109	ENGL	1110	3N0	3	Composition I		ONLINE	Hochhalter, Gina	\$50			x	
32124	ENGL	1120	301	3	Composition II	TR	1:30 pm-2:45 pm	Brown, Shauma		x			
32126	ENGL	1120	3N0	3	Composition II		ONLINE	D'Amour, Linda	\$50			x	
32804	ENGL	1410	3N0	3	Introduction to Literature		ONLINE	Urioste, Robin	\$50			x	
32824	ENGL	2210	301	3	Professional & Technical Comm	MW	10:30 am-11:45 am	Hochhalter, Gina		x			
32132	ENGL	2210	3N0	3	Professional & Technical Comm		ONLINE	Hochhalter, Gina	\$50			x	

## Entrepreneurship

CRN	SUBJ	NUM	SEC	HRS	TITLE	DAYS	TIME	INSTRUCTOR	FEES	COURSE MODE OPTIONS			
										ON CAMPUS	LIVE ONLINE	ONLINE	HYBRID
32435	ENTR	2110	3N0	3	Small Business Management		ONLINE	Reed, Melissa	\$50			x	

## Esthetics/Nail Tech

The Esthetics/Nail Tech program is a combined program that runs Monday-Thursday from 8 a.m. to 5 p.m. To apply students should call 575.769.4945 or stop by Room 403. Students will need to fill out a Cosmetology application, submit high school transcripts to the Office of Admissions, and meet the Accuplacer score requirements prior to being accepted into the program. Applications are now being accepted for Fall 2024 and Fall 2025.

## Exercise Science (HPE Academic Courses)

CRN	SUBJ	NUM	SEC	HRS	TITLE	DAYS	TIME	INSTRUCTOR	FEES	COURSE MODE OPTIONS			
										ON CAMPUS	LIVE ONLINE	ONLINE	HYBRID
32358	EXSC	1110	3N0	2	Youth Fitness		ONLINE	Heath, Bradley	\$50			x	

## Film & Digital Media Art

CRN	SUBJ	NUM	SEC	HRS	TITLE	DAYS	TIME	INSTRUCTOR	FEES	COURSE MODE OPTIONS			
										ON CAMPUS	LIVE ONLINE	ONLINE	HYBRID
32663	FDMA	2713	3N0	3	Computer 2D Animation		ONLINE	Hurlebusch, Judith	\$50			x	

## First Year Experience

CRN	SUBJ	NUM	SEC	HRS	TITLE	DAYS	TIME	INSTRUCTOR	FEES	COURSE MODE OPTIONS			
										ON CAMPUS	LIVE ONLINE	ONLINE	HYBRID
<b>32753</b>	FYEX	1113	301	5	Academic Literacy	MW	12:00 pm-2:30 pm	Urioste, Robin		x			
<b>32704</b>	FYEX	1113	302	5	Academic Literacy	TR	9:15 am-11:45 am	Hochhalter, Gina		x			
<b>32592</b>	FYEX	1113	3N0	5	Academic Literacy		ONLINE	D'Amour, Linda	\$50			x	

## Health Education (HPE Academic Courses)

CRN	SUBJ	NUM	SEC	HRS	TITLE	DAYS	TIME	INSTRUCTOR	FEES	COURSE MODE OPTIONS			
										ON CAMPUS	LIVE ONLINE	ONLINE	HYBRID
<b>32300</b>	HLED	1120	3B0	2	Am Red Cross First Aid CPR/AED		ONLINE	Burns, Karen	\$55			x	
<b>32297</b>	HLED	1130	3N0	3	Concepts of Health & Wellness		ONLINE	TBD	\$50			x	
<b>32298</b>	HLED	1220	3N0	2	Personal Health Management		ONLINE	Heath, Bradley	\$50			x	
<b>32299</b>	HLED	2510	3N0	3	History & Philosophy of PE		ONLINE	TBD	\$50			x	

## History

CRN	SUBJ	NUM	SEC	HRS	TITLE	DAYS	TIME	INSTRUCTOR	FEES	COURSE MODE OPTIONS			
										ON CAMPUS	LIVE ONLINE	ONLINE	HYBRID
<b>32135</b>	HIST	1110	301	3	United States History I	TR	10:30 am-11:45 am	Bridinger De Leon, Vicki		x			
<b>32137</b>	HIST	1110	3N0	3	United States History I		ONLINE	Anderson, Aaron	\$50			x	
<b>32150</b>	HIST	1120	301	3	United States History II	MW	9:00 am-10:15 am	Anderson, Aaron		x			
<b>32152</b>	HIST	1120	3N0	3	United States History II		ONLINE	Anderson, Aaron	\$50			x	
<b>32148</b>	HIST	1130	3N0	3	World History I		ONLINE	Anderson, Aaron	\$50			x	
<b>32149</b>	HIST	1140	3N0	3	World History II		ONLINE	Anderson, Aaron	\$50			x	
<b>32806</b>	HIST	1160	3N0	3	Western Civilization II		ONLINE	Anderson, Aaron	\$50			x	
<b>32733</b>	HIST	2110	301	3	Survey of New Mexico History	TR	12:00 pm-1:15 pm	Bridinger De Leon, Vicki		x			
<b>32167</b>	HIST	2110	3N0	3	Survey of New Mexico History		ONLINE	Bridinger De Leon, Vicki	\$50			x	

## Humanities

CRN	SUBJ	NUM	SEC	HRS	TITLE	DAYS	TIME	INSTRUCTOR	FEES	COURSE MODE OPTIONS			
										ON CAMPUS	LIVE ONLINE	ONLINE	HYBRID
<b>32171</b>	HUMN	1110	3N0	3	Intro to World Humanities I		ONLINE	Henry, Robin	\$50			x	
<b>32172</b>	HUMN	2110	3N0	3	Intro to World Humanities II		ONLINE	Henry, Robin	\$50			x	

## Industrial Technology

The Industrial Technology program offers concentrations in Plant Operations & Equipment and Wind Energy. The program runs Monday - Friday from 8 a.m. to 12 p.m. To apply students should call 575.769.4945 or stop by Room 403. Students will need to fill out an OT application and meet the Accuplacer score requirements prior to being accepted into the program. Applications are now being accepted for Fall 2024 and Spring 2025.

## Legal Studies (Paralegal)

CRN	SUBJ	NUM	SEC	HRS	TITLE	DAYS	TIME	INSTRUCTOR	FEES	COURSE MODE OPTIONS			
										ON CAMPUS	LIVE ONLINE	ONLINE	HYBRID
30452	LEST	102	3N0	3	Intro to Legal Asst Studies		ONLINE	Rowley, Richard	\$50			X	
32434	LEST	108	3N0	3	Administrative Law		ONLINE	Talbert, Laura	\$50			X	
30266	LEST	220	3N0	3	Family Law		ONLINE	Talbert, Laura	\$50			X	
32826	LEST	281	3N0	3	Real Estate Law		ONLINE	Talbert, Laura	\$50			X	

## Management

CRN	SUBJ	NUM	SEC	HRS	TITLE	DAYS	TIME	INSTRUCTOR	FEES	COURSE MODE OPTIONS			
										ON CAMPUS	LIVE ONLINE	ONLINE	HYBRID
32695	MGMT	2110	301	3	Principles of Management	MW	10:30 am-11:45 am	Reed, Melissa		X			

## Marketing

CRN	SUBJ	NUM	SEC	HRS	TITLE	DAYS	TIME	INSTRUCTOR	FEES	COURSE MODE OPTIONS			
										ON CAMPUS	LIVE ONLINE	ONLINE	HYBRID
32195	MKTG	2110	3N0	3	Principles of Marketing		ONLINE	Reed, Melissa	\$50			X	

## Mathematics

CRN	SUBJ	NUM	SEC	HRS	TITLE	DAYS	TIME	INSTRUCTOR	FEES	COURSE MODE OPTIONS			
										ON CAMPUS	LIVE ONLINE	ONLINE	HYBRID
32189	MATH	1130	301	3	Survey of Mathematics	T	6:00 pm-8:30 pm	TBD		X			
32190	MATH	1130	302	3	Survey of Mathematics	MW	12:00 pm-1:15 pm	Brown, Jessica		X			
32191	MATH	1130	303	3	Survey of Mathematics	TR	1:30 pm-2:45 pm	Brown, Jessica		X			
32192	MATH	1130	3N0	3	Survey of Mathematics		ONLINE	Brown, Jessica	\$50			X	
32175	MATH	1215	301	4	Intermediate Algebra	TR	12:00 pm-1:40 pm	TBD		X			
32176	MATH	1215	3N0	4	Intermediate Algebra		ONLINE	Finney, Brandon	\$50			X	
32185	MATH	1220	301	3	College Algebra	MW	12:00 pm-1:15 pm	TBD		X			
32600	MATH	1220	302	3	College Algebra	MW	1:30 pm-2:45 pm	TBD		X			
32188	MATH	1220	3N0	3	College Algebra		ONLINE	Finney, Brandon	\$50			X	
32808	MATH	1230	301	3	Trigonometry	TR	10:30 am-11:45 am	Brown, Jessica		X			
32809	MATH	1230	3N0	3	Trigonometry		ONLINE	Brown, Jessica	\$50			X	
32228	MATH	1350	301	4	Introduction to Statistics	TR	9:00 am-10:40 am	TBD		X			
32229	MATH	1350	3N0	4	Introduction to Statistics		ONLINE	TBD	\$50			X	
32692	MATH	1512	3Z0	4	Calculus I	TR	9:00 am-10:40 am	Finney, Brandon	\$25	X	X	X	
32672	MATH	1522	3Z0	4	Calculus II	TR	12:00 pm-1:40 pm	Finney, Brandon	\$25	X	X	X	
32675	MATH	2531	3Z0	4	Calculus III	MW	9:00 am-10:40 am	Finney, Brandon	\$25	X	X	X	

## Music

CRN	SUBJ	NUM	SEC	HRS	TITLE	DAYS	TIME	INSTRUCTOR	FEES	COURSE MODE OPTIONS			
										ON CAMPUS	LIVE ONLINE	ONLINE	HYBRID
32197	MUSC	1130	3N0	3	Music Appreciation: Western		ONLINE	Sena, Sarah	\$50			X	
32196	MUSC	1220	301	2	Fund of Piano for Non-Majors	T	6:00 pm-7:40 pm	Dawkins, Lori		X			

## Nail Tech/Esthetics

The Nail Tech/Esthetics program is a combined program that runs Monday-Thursday from 8 a.m. to 5 p.m. To apply students should call 575.769.4945 or stop by Room 403. Students will need to fill out a Cosmetology application, submit high school transcripts to the Office of Admissions, and meet the Accuplacer score requirements prior to being accepted into the program. Applications are now being accepted for Fall 2024 and Fall 2025.

## Nursing

CRN	SUBJ	NUM	SEC	HRS	TITLE	DAYS	TIME	INSTRUCTOR	FEES	COURSE MODE OPTIONS			
										ON CAMPUS	LIVE ONLINE	ONLINE	HYBRID
31389	NSG	105	3N0	3	Medical Terminology		ONLINE	West, Toni	\$50			X	
31715	NSG	128	3N0	4	Pathophysiology		ONLINE	McGill, Shawna	\$50			X	
31749	NSG	128	3N1	4	Pathophysiology		ONLINE	McGill, Shawna	\$50			X	
31847	NSG	150	3N0	3	Healthcare Ethics		ONLINE	Soto, Elena	\$50			X	

The Nursing Program runs Monday-Thursday with exams usually given on Fridays. The application is available at [clovis.edu/nursing](https://clovis.edu/nursing) and should be submitted along with transcripts to the Office of Admissions. Deadlines to submit applications are July 1 for Fall and October 1 for Spring.

## Nursing Assistant

CRN	SUBJ	NUM	SEC	HRS	TITLE	DAYS	TIME	INSTRUCTOR	FEES	COURSE MODE OPTIONS			
										ON CAMPUS	LIVE ONLINE	ONLINE	HYBRID
32743	NA	101	3B0	6	Nursing Assistant	MW	1:00 pm-3:30 pm	West, Toni	\$80				X
32744	NA	101	3B1	6	Nursing Assistant	TR	1:00 pm-3:30 pm	Soto, Elena	\$80				X
32810	NA	101	3B2	6	Nursing Assistant	MW	5:30 pm-8:00 pm	Soto, Elena/West, Toni	\$80				X

## Nutrition

CRN	SUBJ	NUM	SEC	HRS	TITLE	DAYS	TIME	INSTRUCTOR	FEES	COURSE MODE OPTIONS			
										ON CAMPUS	LIVE ONLINE	ONLINE	HYBRID
32282	NUTR	2110	3N0	3	Human Nutrition		ONLINE	Bull, Shalon	\$50			X	

## Occupational Technology

CRN	SUBJ	NUM	SEC	HRS	TITLE	DAYS	TIME	INSTRUCTOR	FEES	COURSE MODE OPTIONS			
										ON CAMPUS	LIVE ONLINE	ONLINE	HYBRID
30310	OT	122	301	2	Woodworking I	M	6:45 pm-9:15 pm	Oborny, Francis		X			
30314	OT	123	301	2	Woodworking II	M	6:45 pm-9:15 pm	Oborny, Francis		X			
31117	OT	124	301	2	Cabinet Making I	W	6:45 pm-9:15 pm	Oborny, Francis		X			
31118	OT	125	301	2	Cabinet Making II	W	6:45 pm-9:15 pm	Oborny, Francis		X			

## Philosophy

CRN	SUBJ	NUM	SEC	HRS	TITLE	DAYS	TIME	INSTRUCTOR	FEES	COURSE MODE OPTIONS			
										ON CAMPUS	LIVE ONLINE	ONLINE	HYBRID
32261	PHIL	1120	3N0	3	Logic, Reason & Critl Thinking		ONLINE	TBD	\$50			X	
32199	PHIL	2110	3N0	3	Introduction to Ethics		ONLINE	TBD	\$50			X	
32198	PHIL	2230	3N0	3	Philosophical Thought		ONLINE	TBD	\$50			X	

## Phlebotomy

CRN	SUBJ	NUM	SEC	HRS	TITLE	DAYS	TIME	INSTRUCTOR	FEES	COURSE MODE OPTIONS			
										ON CAMPUS	LIVE ONLINE	ONLINE	HYBRID
<b>31925</b>	PHLB	102	3V0	3	Intro to Medical Lab Theory	MW	8:00 am-10:30 am	Meeks, Garrett		x			
<b>31949</b>	PHLB	102	3V1	3	Intro to Medical Lab Theory	TR	8:00 am-10:30 am	Meeks, Garrett		x			
<b>31926</b>	PHLB	103	3V0	3	Phlebotomy Theory	MW	8:00 am-10:30 am	Meeks, Garrett	\$90	x			
<b>31950</b>	PHLB	103	3V1	3	Phlebotomy Theory	TR	8:00 am-10:30 am	Meeks, Garrett	\$90	x			
<b>31928</b>	PHLB	103L	3V0	2	Phlebotomy Lab	MW	10:30 am-12:30 pm	Meeks, Garrett		x			
<b>31951</b>	PHLB	103L	3V1	2	Phlebotomy Lab	TR	10:30 am-12:30 pm	Meeks, Garrett		x			
<b>31930</b>	PHLB	104	3V0	2	Clinical Phlebotomy	MW	1:30 pm-3:30 pm	Meeks, Garrett		x			
<b>31952</b>	PHLB	104	3V1	2	Clinical Phlebotomy	TR	1:30 pm-3:30 pm	Meeks, Garrett		x			

*Students are required to register concurrently for all four of the Phlebotomy courses listed above.*

## Physical Education (HPE Activity Courses)

CRN	SUBJ	NUM	SEC	HRS	TITLE	DAYS	TIME	INSTRUCTOR	FEES	COURSE MODE OPTIONS			
										ON CAMPUS	LIVE ONLINE	ONLINE	HYBRID
<b>32333</b>	PHED	1110	301	1	Dance: Beginning Belly Dancing	M	6:00 pm-7:40 pm	Chavez, Yolanda		x			
<b>32334</b>	PHED	1110	302	1	Dance: Country & Western Dance	T	6:15 pm-7:55 pm	Boney, Debbie		x			
<b>32677</b>	PHED	1110	303	1	Dance: Aerobic Dance	MW	9:00 am-9:50 am	Mulhair, Amanda		x			
<b>32722</b>	PHED	1210	301	1	Basketball	T	6:00 pm-7:40 pm	TBD		x			
<b>32735</b>	PHED	1280	301	1	Volleyball	R	5:30 pm-6:50 pm	Roberts, Valerie		x			
<b>32549</b>	PHED	1320	301	1	Aqua Fit: Senior Aquatics	TR	3:00 pm-3:50 pm	Williamson, Christine	\$20	x			
<b>32303</b>	PHED	1320	302	1	Aqua Fit: Water Aerobics	MW	8:00 am-8:50 am	TBD	\$20	x			
<b>32304</b>	PHED	1320	303	1	Aqua Fit: Water Aerobics	MW	9:00 am-9:50 am	Arnett, Emily	\$20	x			
<b>32305</b>	PHED	1320	304	1	Aqua Fit: Water Aerobics	MW	4:00 pm-4:50 pm	TBD	\$20	x			
<b>32307</b>	PHED	1320	305	1	Aqua Fit: Water Aerobics	TR	8:00 am-8:50 am	TBD	\$20	x			
<b>32308</b>	PHED	1320	306	1	Aqua Fit: Water Aerobics	TR	4:00 pm-4:50 pm	TBD	\$20	x			
<b>32548</b>	PHED	1320	307	1	Aqua Fit: Water Aerobics	TR	5:00 pm-5:50 pm	Williamson, Christine	\$20	x			
<b>32436</b>	PHED	1410	301	1	Yoga: Beginning Yoga	M	4:00 pm-5:40 pm	Chavez, Yolanda		x			
<b>32311</b>	PHED	1410	302	1	Yoga: Beginning Yoga	W	2:30 pm-4:10 pm	Chavez, Yolanda		x			
<b>32315</b>	PHED	1430	301	1	Pilates	MW	8:00 am-8:50 am	Williamson, Christine		x			
<b>32326</b>	PHED	1510	301	1	Training: Body Sculpting	MW	1:00 pm-1:50 pm	Williamson, Christine		x			

*This section is recommended for senior citizens.*

<b>32739</b>	PHED	1510	302	1	Training: Body Sculpting	TR	8:00 am-8:50 am	Williamson, Christine		x			
<b>32338</b>	PHED	1510	303	1	Training: Beg. Weight Training	MW	4:00 pm-4:50 pm	TBD		x			
<b>32740</b>	PHED	1510	304	1	Training: Beg. Weight Training	TR	12:00 pm-12:50 pm	Heath, Bradley		x			
<b>32341</b>	PHED	1510	305	1	Training: Circuit Training	TR	9:00 am-9:50 am	Arnett, Emily		x			
<b>32741</b>	PHED	1510	306	1	Training: Circuit Training	TR	5:00 pm-5:50 pm	TBD		x			
<b>32736</b>	PHED	1510	307	1	Training: Bootcamp	TR	5:00 pm-5:50 pm	Arnett, Emily		x			
<b>32742</b>	PHED	1510	308	1	Training: Kickboxing	TR	6:00 pm-6:50 pm	Watson, Michael		x			
<b>32329</b>	PHED	1610	301	1	Fitness for Life		TBD	Heath, Brad		x			
<b>32317</b>	PHED	1620	301	1	Fitness: Indoor Cycling	MW	6:10 am-7:00 am	O'Rear, Tammi		x			
<b>32568</b>	PHED	1620	302	1	Fitness: Indoor Cycling	MW	9:00 am-9:50 am	Lamb, Kimberly		x			
<b>32320</b>	PHED	1620	303	1	Fitness: Indoor Cycling	TR	6:10 am-7:00 am	O'Rear, Tammi		x			
<b>32324</b>	PHED	1620	304	1	Fitness: Core Fitness I	MW	12:00 pm-12:50 pm	Williamson, Christine		x			
<b>32325</b>	PHED	1620	305	1	Fitness: Walking for Fitness	MW	10:30 am-11:20 am	Lamb, Kimberly		x			
<b>32316</b>	PHED	1710	301	1	Martial Arts: Self-Defense	T	7:00 pm-8:40 pm	Watson, Michael		x			
<b>32348</b>	PHED	2230	301	1	Ind Sport II: Int. Racquetball	MW	5:30 pm-6:20 pm	Bussen, Mark		x			

## Physical Education (HPE Activity Courses) *Continued*

CRN	SUBJ	NUM	SEC	HRS	TITLE	DAYS	TIME	INSTRUCTOR	FEES	COURSE MODE OPTIONS			
										ON CAMPUS	LIVE ONLINE	ONLINE	HYBRID
32357	PHED	2996	301	1	Topics in PE: Mindful/Meditatn	W	5:00 pm-6:40 pm	Chavez, Yolanda		x			
32349	PHED	2996	302	1	Topics in PE: Tai Chi	TF	1:00 pm-1:50 pm	McConnell, Heather		x			
32721	PHED	2996	303	1	Topics in PE: Tai Chi	MW	12:00 pm-12:50 pm	Burch, Paul		x			
32828	PHED	2996	304	1	Topics in PE: Water Tai Chi	TR	12:00 pm-12:50 pm	Burch, David		x			

## Physical Therapist Assistant

The Physical Therapist Assistant Program runs Tuesday-Friday. The application is available at [clovis.edu/pta](http://clovis.edu/pta) and should be submitted along with transcripts and observation hours log to the Office of Admissions. The deadline to submit applications is July 1.

## Physics

CRN	SUBJ	NUM	SEC	HRS	TITLE	DAYS	TIME	INSTRUCTOR	FEES	COURSE MODE OPTIONS			
										ON CAMPUS	LIVE ONLINE	ONLINE	HYBRID
32705	PHYS	1115C	3N0	4	Survey of Physics with Lab		ONLINE	TBD	\$50			x	
32827	PHYS	1230C	3Z0	4	Algebra-Based Physics/Lab	MW	9:00 am-11:30 am	Brown, Jessica	\$25	x	x	x	

## Political Science

CRN	SUBJ	NUM	SEC	HRS	TITLE	DAYS	TIME	INSTRUCTOR	FEES	COURSE MODE OPTIONS			
										ON CAMPUS	LIVE ONLINE	ONLINE	HYBRID
32202	POLS	1120	3N0	3	American National Government		ONLINE	Rapp, Gregory	\$50			x	

## Psychology

CRN	SUBJ	NUM	SEC	HRS	TITLE	DAYS	TIME	INSTRUCTOR	FEES	COURSE MODE OPTIONS			
										ON CAMPUS	LIVE ONLINE	ONLINE	HYBRID
32230	PSYC	1110	301	3	Introduction to Psychology	M	6:45 pm-9:15 pm	Smith, Marcus		x			
32233	PSYC	1110	302	3	Introduction to Psychology	MW	10:30 am-11:45 am	TBD		x			
32232	PSYC	1110	303	3	Introduction to Psychology	TR	9:00 am-10:15 am	TBD		x			
32234	PSYC	1110	304	3	Introduction to Psychology	TR	3:00 pm-4:15 pm	TBD		x			
32236	PSYC	1110	3N0	3	Introduction to Psychology		ONLINE	TBD	\$50			x	
32250	PSYC	2120	301	3	Developmental Psychology	T	6:45 pm-9:15 pm	TBD		x			
32251	PSYC	2120	302	3	Developmental Psychology	MW	9:00 am-10:15 am	TBD		x			
32252	PSYC	2120	3N0	3	Developmental Psychology		ONLINE	Sena, Mindy	\$50			x	
32256	PSYC	2130	301	3	Adolescent Psychology	M	6:00 pm-8:30 pm	Christian, Hayley		x			
32254	PSYC	2140	301	3	Child Psychology	TR	10:30 am-11:45 am	TBD		x			
32255	PSYC	2140	3N0	3	Child Psychology		ONLINE	TBD	\$50			x	
32550	PSYC	2210	3N0	3	Abnormal Psychology		ONLINE	Smith, Marcus	\$50			x	
32258	PSYC	2250	3N0	3	Brain and Behavior		ONLINE	Smith, Marcus	\$50			x	
32551	PSYC	2310	3N0	3	Drugs and Behavior		ONLINE	Grussendorf, Erika	\$50			x	

## Radiologic Technology

The Radiology Program runs Monday-Thursday. The application is available at [clovis.edu/radt](http://clovis.edu/radt) and should be submitted along with transcripts to the Office of Admissions. The deadline to submit applications is July 1.

## Religion

CRN	SUBJ	NUM	SEC	HRS	TITLE	DAYS	TIME	INSTRUCTOR	FEES	COURSE MODE OPTIONS			
										ON CAMPUS	LIVE ONLINE	ONLINE	HYBRID
32815	RELG	1110	3NO	3	Intro to World Religions		ONLINE	Bush, David	\$50			X	
32816	RELG	1126	3NO	3	New Testament		ONLINE	Bush, David	\$50			X	
32817	RELG	2220	3NO	3	Women of the Bible		ONLINE	Kirby, Richard	\$50			X	
32818	RELG	2230	3NO	3	Men of the Bible		ONLINE	Kirby, Richard	\$50			X	

## Sign Language Interpreter

CRN	SUBJ	NUM	SEC	HRS	TITLE	DAYS	TIME	INSTRUCTOR	FEES	COURSE MODE OPTIONS			
										ON CAMPUS	LIVE ONLINE	ONLINE	HYBRID
32206	SIGN	1110	301	3	American Sign Language I	M	6:00 pm-8:30 pm	Guillen, Teresa		X			

## Social Work

CRN	SUBJ	NUM	SEC	HRS	TITLE	DAYS	TIME	INSTRUCTOR	FEES	COURSE MODE OPTIONS			
										ON CAMPUS	LIVE ONLINE	ONLINE	HYBRID
32829	SOWK	2110	3NO	3	Introduction to Human Services & Social Work		ONLINE	Grussendorf, Erika	\$50			X	

## Sociology

CRN	SUBJ	NUM	SEC	HRS	TITLE	DAYS	TIME	INSTRUCTOR	FEES	COURSE MODE OPTIONS			
										ON CAMPUS	LIVE ONLINE	ONLINE	HYBRID
32208	SOCI	1110	301	3	Introduction to Sociology	MW	1:30 pm-2:45 pm	Richeson, J		X			
32209	SOCI	1110	3NO	3	Introduction to Sociology		ONLINE	Richeson, J	\$50			X	
32211	SOCI	2240	3NO	3	Soc Intimate Relations/Family		ONLINE	Richeson, J	\$50			X	

## Spanish

CRN	SUBJ	NUM	SEC	HRS	TITLE	DAYS	TIME	INSTRUCTOR	FEES	COURSE MODE OPTIONS			
										ON CAMPUS	LIVE ONLINE	ONLINE	HYBRID
32819	SPAN	1110	301	4	Spanish I	MW	12:00 pm-1:15 pm	Guillen, Teresa		X			
32213	SPAN	1110	3NO	4	Spanish I		ONLINE	Guillen, Teresa	\$50			X	
32684	SPAN	1120	3LO	4	Spanish II	R	6:00 pm-9:15 pm	Guillen, Teresa	\$50		X		
32227	SPAN	1120	3NO	4	Spanish II		ONLINE	Guillen, Teresa	\$50			X	

## Transitional Studies

CRN	SUBJ	NUM	SEC	HRS	TITLE	DAYS	TIME	INSTRUCTOR	FEES	COURSE MODE OPTIONS			
										ON CAMPUS	LIVE ONLINE	ONLINE	HYBRID
31823	TRST	0930	301	4	Basic Algebra I	T	6:00 pm-9:15 pm	TBD		X			
31877	TRST	0930	3NO	4	Basic Algebra I		ONLINE	TBD	\$50			X	
31938	TRST	0931	301	4	Basic Algebra II	T	6:00 pm-9:15 pm	TBD		X			
31934	TRST	0931	3NO	4	Basic Algebra II		ONLINE	TBD	\$50			X	

## Welding

CRN	SUBJ	NUM	SEC	HRS	TITLE	DAYS	TIME	INSTRUCTOR	FEES	COURSE MODE OPTIONS			
										ON CAMPUS	LIVE ONLINE	ONLINE	HYBRID
31626	WELD	272	301	3	Gen Welding for the Hobbyist	M	5:30 pm-8:30 pm	Poindexter, Sean	\$380	x			

Other than the hobbyist class listed above, the full-time Welding program runs Monday Thursday from 7 a.m. to 12 p.m. To apply students should call 575.769.4945 or stop by Room 403. Students will need to complete an OT application and meet the Accuplacer score requirements prior to being accepted into the program. Applications are now being accepted for Fall 2024 and Spring 2025.

## First 8-Weeks

August 19 - October 11

## Art History

CRN	SUBJ	NUM	SEC	HRS	TITLE	DAYS	TIME	INSTRUCTOR	FEES	COURSE MODE OPTIONS			
										ON CAMPUS	LIVE ONLINE	ONLINE	HYBRID
32556	ARTH	1110	3N4	3	Art Appreciation		ONLINE	TBD	\$50			x	

## Biology

CRN	SUBJ	NUM	SEC	HRS	TITLE	DAYS	TIME	INSTRUCTOR	FEES	COURSE MODE OPTIONS			
										ON CAMPUS	LIVE ONLINE	ONLINE	HYBRID
32535	BIOL	2210C	3N4	4	Human Anat/Phys I Lec/Lab		ONLINE	Kuykendall, Todd	\$50			x	

## Business and Office Technology

CRN	SUBJ	NUM	SEC	HRS	TITLE	DAYS	TIME	INSTRUCTOR	FEES	COURSE MODE OPTIONS			
										ON CAMPUS	LIVE ONLINE	ONLINE	HYBRID
31424	BOFT	101	3N4	1	Personal Keyboarding		ONLINE	Ewers, Dannette	\$50			x	
32657	BOFT	102	3N4	1	Computerized 10-Key Operations		ONLINE	Ewers, Dannette	\$50			x	

## Chemistry

CRN	SUBJ	NUM	SEC	HRS	TITLE	DAYS	TIME	INSTRUCTOR	FEES	COURSE MODE OPTIONS			
										ON CAMPUS	LIVE ONLINE	ONLINE	HYBRID
32428	CHEM	1120C	3N4	4	Intro to Chem Lec/Lab Non-Maj		ONLINE	TBD	\$50			x	

## Communication

CRN	SUBJ	NUM	SEC	HRS	TITLE	DAYS	TIME	INSTRUCTOR	FEES	COURSE MODE OPTIONS			
										ON CAMPUS	LIVE ONLINE	ONLINE	HYBRID
32687	COMM	1130	3N4	3	Public Speaking		ONLINE	Knight, Kelsey	\$50			x	
32066	COMM	1130	3Z4	3	Public Speaking	MW	4:30 pm-7:00 pm	Knight, Kelsey	\$25	x			
<i>This class meets at CAFB.</i>													
32051	COMM	2120	3N4	3	Interpersonal Communication		ONLINE	Thomas, Celeste	\$50			x	



## Computer Information Systems

CRN	SUBJ	NUM	SEC	HRS	TITLE	DAYS	TIME	INSTRUCTOR	FEES	COURSE MODE OPTIONS			
										ON CAMPUS	LIVE ONLINE	ONLINE	HYBRID
<b>31906</b>	CIS	106	3N4	1	Windows Fundamentals		ONLINE	Davis, Patrick	\$50			X	
<i>CIS 106 will be taught using Windows 11.</i>													

## Economics

CRN	SUBJ	NUM	SEC	HRS	TITLE	DAYS	TIME	INSTRUCTOR	FEES	COURSE MODE OPTIONS			
										ON CAMPUS	LIVE ONLINE	ONLINE	HYBRID
<b>32561</b>	ECON	2110	3N4	3	Macroeconomic Principles		ONLINE	Kuykendall, Robin	\$50			X	

## English

CRN	SUBJ	NUM	SEC	HRS	TITLE	DAYS	TIME	INSTRUCTOR	FEES	COURSE MODE OPTIONS			
										ON CAMPUS	LIVE ONLINE	ONLINE	HYBRID
<b>32563</b>	ENGL	1110	3N4	3	Composition I		ONLINE	Urioste, Robin	\$50			X	
<b>32689</b>	ENGL	1110	3Z4	3	Composition I	TR	4:30 pm-7:00 pm	Brown, Shauma	\$25	X	X	X	
<i>This class meets at CAFB.</i>													
<b>32564</b>	ENGL	1120	3N4	3	Composition II		ONLINE	Hochhalter, Gina	\$50			X	

## First Year Experience

CRN	SUBJ	NUM	SEC	HRS	TITLE	DAYS	TIME	INSTRUCTOR	FEES	COURSE MODE OPTIONS			
										ON CAMPUS	LIVE ONLINE	ONLINE	HYBRID
<b>32593</b>	FYEX	1113	3N4	5	Academic Literacy		ONLINE	Hochhalter, Gina	\$50			X	

## Legal Studies

CRN	SUBJ	NUM	SEC	HRS	TITLE	DAYS	TIME	INSTRUCTOR	FEES	COURSE MODE OPTIONS			
										ON CAMPUS	LIVE ONLINE	ONLINE	HYBRID
<b>30720</b>	LEST	105	3N4	3	Legal Wrtg Term / Research I		ONLINE	Rowley, Richard	\$50			X	

## Occupational Technology

CRN	SUBJ	NUM	SEC	HRS	TITLE	DAYS	TIME	INSTRUCTOR	FEES	COURSE MODE OPTIONS			
										ON CAMPUS	LIVE ONLINE	ONLINE	HYBRID
<b>30312</b>	OT	122	330	2	Woodworking I	TR	6:45 pm-9:15 pm	Oborny, Robert		X			
<b>30316</b>	OT	123	330	2	Woodworking II	TR	6:45 pm-9:15 pm	Oborny, Robert		X			

## Physical Education (HPE Activity Courses)

CRN	SUBJ	NUM	SEC	HRS	TITLE	DAYS	TIME	INSTRUCTOR	FEES	COURSE MODE OPTIONS			
										ON CAMPUS	LIVE ONLINE	ONLINE	HYBRID
<b>32343</b>	PHED	1230	330	1	Individual Sport: Golf	MW	8:00 am-9:40 am	Lincoln, William		X			
<i>Students must provide their own golf clubs.</i>													
<b>32346</b>	PHED	1230	331	1	Individual Sport: Tennis	MW	8:00 am-9:40 am	Heath, Bradley		X			
<b>32321</b>	PHED	1620	330	1	Fitness: Indoor Cycling	TR	9:00 am-10:40 am	Roberts, Valerie		X			
<b>32347</b>	PHED	2230	331	1	Individ. Sport II: Int. Tennis	TR	6:00 pm-7:40 pm	Heath, Bradley		X			
<b>32825</b>	PHED	2996	330	1	Topics in PE: Pickleball	MW	4:00 pm-5:40 pm	Heath, Bradley		X			

## Psychology

CRN	SUBJ	NUM	SEC	HRS	TITLE	DAYS	TIME	INSTRUCTOR	FEES	COURSE MODE OPTIONS			
										ON CAMPUS	LIVE ONLINE	ONLINE	HYBRID
32571	PSYC	1110	3N4	3	Introduction to Psychology		ONLINE	TBD	\$50			X	

## Transitional Studies

CRN	SUBJ	NUM	SEC	HRS	TITLE	DAYS	TIME	INSTRUCTOR	FEES	COURSE MODE OPTIONS			
										ON CAMPUS	LIVE ONLINE	ONLINE	HYBRID
32553	TRST	0930	3N4	4	Basic Algebra I		ONLINE	TBD	\$50			X	

## Second 8-Weeks

October 14 - December 8

## Biology

CRN	SUBJ	NUM	SEC	HRS	TITLE	DAYS	TIME	INSTRUCTOR	FEES	COURSE MODE OPTIONS			
										ON CAMPUS	LIVE ONLINE	ONLINE	HYBRID
32536	BIOL	2225C	3N7	4	Human Anat/Phys II Lec/Lab		ONLINE	Kuykendall, Todd	\$50			X	

## Business Administration

CRN	SUBJ	NUM	SEC	HRS	TITLE	DAYS	TIME	INSTRUCTOR	FEES	COURSE MODE OPTIONS			
										ON CAMPUS	LIVE ONLINE	ONLINE	HYBRID
32557	BUSA	1110	3N7	3	Introduction to Business		ONLINE	TBD	\$50			X	

## Business Computer Info Systems

CRN	SUBJ	NUM	SEC	HRS	TITLE	DAYS	TIME	INSTRUCTOR	FEES	COURSE MODE OPTIONS			
										ON CAMPUS	LIVE ONLINE	ONLINE	HYBRID
32640	BCIS	1110	3N7	3	Fund of Info Literacy/Systems		ONLINE	Byers, Diana	\$50			X	

*BCIS 1110 covers the Microsoft Office 2019/Office 365 Windows versions of Word, Excel, Access, and PowerPoint.*

## Business and Office Technology

CRN	SUBJ	NUM	SEC	HRS	TITLE	DAYS	TIME	INSTRUCTOR	FEES	COURSE MODE OPTIONS			
										ON CAMPUS	LIVE ONLINE	ONLINE	HYBRID
32511	BOFT	101	3N7	1	Personal Keyboarding		ONLINE	Ewers, Dannette	\$50			X	
30069	BOFT	102	3N7	1	Computerized 10-Key Operations		ONLINE	Ewers, Dannette	\$50			X	
32637	BOFT	115	3N7	3	Workplace and Life Essentials		ONLINE	Turner, Monica	\$50			X	

## Communication

CRN	SUBJ	NUM	SEC	HRS	TITLE	DAYS	TIME	INSTRUCTOR	FEES	COURSE MODE OPTIONS			
										ON CAMPUS	LIVE ONLINE	ONLINE	HYBRID
<a href="#">32558</a>	COMM	1130	3N7	3	Public Speaking		ONLINE	Knight, Kelsey	\$50			X	
<a href="#">32052</a>	COMM	2120	3N7	3	Interpersonal Communication		ONLINE	Thomas, Celeste	\$50			X	

## Computer Information Systems

CRN	SUBJ	NUM	SEC	HRS	TITLE	DAYS	TIME	INSTRUCTOR	FEES	COURSE MODE OPTIONS			
										ON CAMPUS	LIVE ONLINE	ONLINE	HYBRID
<a href="#">31907</a>	CIS	107	3N7	1	Internet Fundamentals		ONLINE	Davis, Patrick	\$50			X	
<i>CIS 107 will be taught using Windows 10/11..</i>													

## Early Childhood Education

CRN	SUBJ	NUM	SEC	HRS	TITLE	DAYS	TIME	INSTRUCTOR	FEES	COURSE MODE OPTIONS			
										ON CAMPUS	LIVE ONLINE	ONLINE	HYBRID
<a href="#">32078</a>	ECED	1110	3N7	3	Child Growth, Dev & Learning		ONLINE	Coburn, Michelle	\$50			X	
<a href="#">32081</a>	ECED	1115	3N7	2	Health, Safety, & Nutrition		ONLINE	Coburn, Michelle	\$50			X	

## Economics

CRN	SUBJ	NUM	SEC	HRS	TITLE	DAYS	TIME	INSTRUCTOR	FEES	COURSE MODE OPTIONS			
										ON CAMPUS	LIVE ONLINE	ONLINE	HYBRID
<a href="#">32562</a>	ECON	2120	3N7	3	Microeconomic Principles		ONLINE	Kuykendall, Robin	\$50		X		

## English

CRN	SUBJ	NUM	SEC	HRS	TITLE	DAYS	TIME	INSTRUCTOR	FEES	COURSE MODE OPTIONS			
										ON CAMPUS	LIVE ONLINE	ONLINE	HYBRID
<a href="#">32519</a>	ENGL	1110	3N7	3	Composition I		ONLINE	D'Amour, Linda	\$50			X	
<a href="#">32127</a>	ENGL	1120	3N7	3	Composition II		ONLINE	Hochhalter, Gina	\$50			X	

## First Year Experience

CRN	SUBJ	NUM	SEC	HRS	TITLE	DAYS	TIME	INSTRUCTOR	FEES	COURSE MODE OPTIONS			
										ON CAMPUS	LIVE ONLINE	ONLINE	HYBRID
<a href="#">32594</a>	FYEX	1113	3N7	5	Academic Literacy		ONLINE	D'Amour, Linda	\$50			X	

## History

CRN	SUBJ	NUM	SEC	HRS	TITLE	DAYS	TIME	INSTRUCTOR	FEES	COURSE MODE OPTIONS			
										ON CAMPUS	LIVE ONLINE	ONLINE	HYBRID
<a href="#">32805</a>	HIST	1110	3N7	3	United States History I		ONLINE	Anderson, Aaron	\$50			X	

## Legal Studies

CRN	SUBJ	NUM	SEC	HRS	TITLE	DAYS	TIME	INSTRUCTOR	FEES	COURSE MODE OPTIONS			
										ON CAMPUS	LIVE ONLINE	ONLINE	HYBRID
31019	LEST	106	3N7	3	Legal Wrtg Terminology Res II		ONLINE	Rowley, Richard	\$50			X	

## Mathematics

CRN	SUBJ	NUM	SEC	HRS	TITLE	DAYS	TIME	INSTRUCTOR	FEES	COURSE MODE OPTIONS			
										ON CAMPUS	LIVE ONLINE	ONLINE	HYBRID
32670	MATH	1130	3Z7	3	Survey of Mathematics	MW	4:30 pm-7:00 pm	TBD	\$25	X	X	X	
<i>This class meets at CAFB.</i>													

## Nursing

CRN	SUBJ	NUM	SEC	HRS	TITLE	DAYS	TIME	INSTRUCTOR	FEES	COURSE MODE OPTIONS			
										ON CAMPUS	LIVE ONLINE	ONLINE	HYBRID
31391	NSG	105	3N7	3	Medical Terminology		ONLINE	Zamora, Andrea	\$50			X	
31778	NSG	128	3N7	4	Pathophysiology		ONLINE	McGill, Shawna	\$50			X	
32715	NSG	150	3N7	3	Healthcare Ethics		ONLINE	Soto, Elena	\$50			X	

## Nutrition

CRN	SUBJ	NUM	SEC	HRS	TITLE	DAYS	TIME	INSTRUCTOR	FEES	COURSE MODE OPTIONS			
										ON CAMPUS	LIVE ONLINE	ONLINE	HYBRID
CRN	NUTR	2110	3N7	3	Human Nutrition		ONLINE	Bull, Shalon	\$50			X	

## Occupational Technology

CRN	SUBJ	NUM	SEC	HRS	TITLE	DAYS	TIME	INSTRUCTOR	FEES	COURSE MODE OPTIONS			
										ON CAMPUS	LIVE ONLINE	ONLINE	HYBRID
30313	OT	122	335	2	Woodworking I	TR	6:45 pm-9:15 pm	Oborny, Robert		X			
30317	OT	123	335	2	Woodworking II	TR	6:45 pm-9:15 pm	Oborny, Robert		X			

## Physical Education (HPE Activity Courses)

CRN	SUBJ	NUM	SEC	HRS	TITLE	DAYS	TIME	INSTRUCTOR	FEES	COURSE MODE OPTIONS			
										ON CAMPUS	LIVE ONLINE	ONLINE	HYBRID
32322	PHED	1620	335	1	Fitness: Indoor Cycling	TR	9:00 am-10:40 am	Heath, Bradley		X			
32738	PHED	2996	335	1	Topics in PE: Pickleball	MW	9:00 am-10:40 am	Heath, Bradley		X			
32813	PHED	2996	336	1	Topics in PE: Pickleball	MW	4:00 pm-5:40 pm	Heath, Bradley		X			

## Psychology

CRN	SUBJ	NUM	SEC	HRS	TITLE	DAYS	TIME	INSTRUCTOR	FEES	COURSE MODE OPTIONS			
										ON CAMPUS	LIVE ONLINE	ONLINE	HYBRID
<a href="#">32237</a>	PSYC	1110	3N7	3	<a href="#">Introduction to Psychology</a>		ONLINE	TBD	\$50			X	
<a href="#">32253</a>	PSYC	2120	3N7	3	<a href="#">Developmental Psychology</a>		ONLINE	Sena, Mindy	\$50			X	

## Religion

CRN	SUBJ	NUM	SEC	HRS	TITLE	DAYS	TIME	INSTRUCTOR	FEES	COURSE MODE OPTIONS			
										ON CAMPUS	LIVE ONLINE	ONLINE	HYBRID
<a href="#">32552</a>	RELG	1126	3N7	3	<a href="#">New Testament</a>		ONLINE	Bush, David	\$50			X	
<a href="#">32682</a>	RELG	2230	3N7	3	<a href="#">Men of the Bible</a>		ONLINE	Kirby, Richard	\$50			X	

## Sociology

CRN	SUBJ	NUM	SEC	HRS	TITLE	DAYS	TIME	INSTRUCTOR	FEES	COURSE MODE OPTIONS			
										ON CAMPUS	LIVE ONLINE	ONLINE	HYBRID
<a href="#">32520</a>	SOCI	1110	3N7	3	<a href="#">Introduction to Sociology</a>		ONLINE	Richeson, J	\$50			X	
<a href="#">32718</a>	SOCI	2240	3N7	3	<a href="#">Soc Intimate Relations/Family</a>		ONLINE	Richeson, J	\$50			X	
<a href="#">32210</a>	SOCI	2310	3N7	3	<a href="#">Contemporary Social Problems</a>		ONLINE	Richeson, J	\$50			X	

## Transitional Studies

CRN	SUBJ	NUM	SEC	HRS	TITLE	DAYS	TIME	INSTRUCTOR	FEES	COURSE MODE OPTIONS			
										ON CAMPUS	LIVE ONLINE	ONLINE	HYBRID
<a href="#">32554</a>	TRST	0931	3N7	4	<a href="#">Basic Algebra II</a>		ONLINE	TBD	\$50			X	

## PATHWAY ONLINE SERVICES PORTAL

Pathway is CCC's online services portal for students to access information and services. When you are admitted to CCC, you will be issued a C-Number for accessing your Pathway account. For help with Pathway, please call the CCC Help Desk at [575.769.4969](tel:575.769.4969).

[pathway.clovis.edu](http://pathway.clovis.edu)

- Register, add, or drop classes
- Access Student Email
- View Transcripts
- Access Library Resources
- ...and more!

# REGISTRATION & NEW STUDENT INFO

## ACCUPLACER ASSESSMENT

All students enrolling for the first time in courses with a math component, a writing component, or courses that require extensive reading are required to take the Accuplacer assessment before registering. The Accuplacer assessment is given in the Testing Center. Students are required to register for the appropriate level of classes indicated by the results of the assessment.

The computerized assessment is free and covers mathematics, writing, and reading. Low scores will not keep students from enrolling in college, but some courses and programs have minimum score requirements.

Students may be exempt from taking the Accuplacer assessment if they have other test scores (e.g., ACT/SAT) that demonstrate college level skills. A valid picture identification is required when testing. After completing the assessment, take a copy of your Accuplacer Student Score Report to your Academic Advisor. For more information on the Accuplacer assessment, including Testing Center hours of operation, call the Testing Center at [575.769.4088](tel:575.769.4088).

## ADVISING

All students are encouraged to contact an Advisor prior to registering for assistance with course selection. The following students are required to meet with an Academic Advisor:

- First-time, degree-seeking students
- All Financial Aid students
- Students applying for Veteran's Assistance
- Students returning from academic probation or suspension status

Advisors are available on a walk-in basis. Each Advisor specializes in different major fields and student needs. Please contact the Academic Advising Office at [575.769.4020](tel:575.769.4020) or email [academic.advising@clovis.edu](mailto:academic.advising@clovis.edu) for hours of operation or more information.

## BOOKS AND SUPPLIES

Books and supplies are available at CCC's Bookstore. Please pick up your books prior to your first class meeting. More information regarding book orders and rentals can be found at [clovis.edu/bookstore](http://clovis.edu/bookstore).

## CAMPUS TOURS & STUDENT ORIENTATION

## Textbooks are now more accessible and affordable!

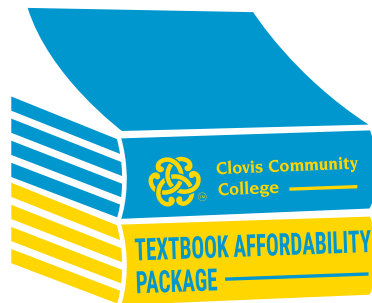

Clovis Community College offers an affordable and convenient option for all your textbooks through the Textbook Affordability Package (TAP). Textbook costs are automatically built into tuition at the time of registration. Students can simply stop by the bookstore and pick up books or have them shipped directly to their homes, by purchasing a shipping label through the bookstore webpage.

### TRADITIONAL TEXTBOOK AFFORDABILITY PACKAGE

This is a textbook rental package and it covers most general education courses. See [clovis.edu/bookstore](http://clovis.edu/bookstore) for a complete list of courses. Students will have the option to purchase the rentals at the end of the semester by paying the difference in rental and purchase cost plus a \$10 purchase fee.

Textbook costs are \$36 per credit hour, which includes textbooks\*\*, lab manuals, and access codes. This fee excludes lab kits or supplies such as dissection kits, art supplies, etc.

\*\* Rentals must be returned at the end of the semester.

### PROGRAMMATIC TEXTBOOK AFFORDABILITY PACKAGE

This is a package in which books are purchased as a bundle in order to offer a lower cost to students. See [clovis.edu/bookstore](http://clovis.edu/bookstore) for a complete list of programmatic textbook fees for the following programs:

- Automotive Technology
- Electrical Maintenance
- Emergency Medical Services (EMS)
- Industrial Technology
- Phlebotomy
- Physical Therapist Assistant
- Nursing
- Radiologic Technology
- Welding

### OPTING OUT OF TAP

Students are opted into this program each semester at the time of registration. Students will receive an email through their student email account that includes an opt out link. Students who opt out are opting out of ALL courses for which they are registered and are responsible for all textbook costs. Students should contact [academic.advising@clovis.edu](mailto:academic.advising@clovis.edu) or [575.769.4020](tel:575.769.4020) for textbook advising. Students must opt out each semester by the deadline in order to receive a refund for the TAP fees. Textbooks will be available the week before classes start. Specific textbook and opt out information will be sent to student email addresses each semester. Deadline to opt out for fall can be found on page 2. For questions about opting out or to schedule delivery, students should contact the bookstore at [bookstore@clovis.edu](mailto:bookstore@clovis.edu) or [575.769.4050](tel:575.769.4050).

Attending orientation is important in answering any questions you may have about your college. If you are interested in scheduling a campus tour, please call [575-769-4025](tel:575-769-4025) or visit [clovis.edu/admissios/tours.aspx](http://clovis.edu/admissios/tours.aspx).

## CLASS CANCELLATIONS

Classes may be canceled for lack of enrollment or if an instructor is unavailable. Please login to your CCC student email via Pathway at [pathway.clovis.edu](http://pathway.clovis.edu) to see if any of your classes have been canceled. If so, please check the online schedule or see an Advisor to select an alternate class.

## CLASSROOM LOCATION

To view your classroom location online, login to Pathway at [pathway.clovis.edu](http://pathway.clovis.edu), click on the **Student Tab**, click on the **Student Detail Schedule** in the Student Quick Links box in the middle column, select your term, and then click **submit**.

Complete classroom locations and instructor listings will be posted at the main entrances of the campus during the first week of classes.

## NOTICE OF NON-DISCRIMINATION

Clovis Community College does not discriminate on the basis of race, color, national origin, ancestry, religion, sex, sexual orientation, spousal affiliation, gender identity, veteran status, physical or mental disability, serious medical condition, or age in its programs and activities. The following personnel have been designated to handle inquiries regarding the non-discrimination policies:

Director of Security  
417 Schepps Blvd. Clovis, NM 88101, Room 134  
[575.769.4144](tel:575.769.4144)

Director of Human Resource Services  
417 Schepps Blvd. Clovis, NM 88101, Room 112  
[575.769.4045](tel:575.769.4045)

Director of Diversity, Equity, and Inclusion  
417 Schepps Blvd. Clovis, NM 88101, Room 138  
[575.769.4184](tel:575.769.4184)

For further information on notice of non-discrimination, visit [wdcrobcolp01.ed.gov/CFAPPS/OCR/contactus.cfm](http://wdcrobcolp01.ed.gov/CFAPPS/OCR/contactus.cfm) for the address and phone number of the office that serves your area, or call [1.800.421.3481](tel:1.800.421.3481).

## PARKING REGISTRATION

Clovis Community College encourages all students to register their vehicles with the Security Office in the Dr. H. A. Miller Student Services Center. You will need your license plate number along with the state of registration, make, model, year, and color of your vehicle to receive your free CCC decal.

## THE OFFICE OF ACCESSIBILITY & RESOURCES

Students who need assistance for a disability or disabling condition or who need help dealing with personal or educational issues can contact the Office of Accessibility and Resources Coordinator/Counselor at [575.769.4121](tel:575.769.4121).

## STUDENT EMAIL

All CCC students will be issued an email address. After you are accepted for admission, you will be sent login instructions to your personal email address. Student email is CCC's primary method of communication with students. Announcements sent to your email account will contain important information including important deadlines and academic progress; therefore, you should check your CCC email account frequently. Your instructors will also use this email address to contact you. For assistance logging in, call [575.769.4969](tel:575.769.4969).

## STUDENT ID CARD

You will need your student ID card to use resources in the Center for Student Success, Health and Fitness Center (gym), Library or to charge your books to your financial aid account in the Bookstore as well as pick up financial aid and/or payroll checks. Your student ID card may also be required for identification upon request from Security staff. Your first student ID card is free. A \$10 replacement fee is required for lost cards and should be paid at the Business Office cashier's window.

Please bring your class schedule and a picture ID to the Security Office in the Dr. H. A. Miller Student Services Center to receive your student ID card.

## WITHDRAWING FROM CLASSES

If you withdraw from a class after the last day of late registration, the withdrawal will be recorded as "W" on your transcript. If you feel you will be unable to complete a course successfully, you must withdraw in order to avoid a failing grade for the course. You can withdraw online at [pathway.clovis.edu](http://pathway.clovis.edu) or complete a form in the Admissions and Records Office prior to the deadline. For more information, please contact the Admissions and Records office at [575.769.4025](tel:575.769.4025).

Please see the Academic Calendar at [clovis.edu/academiccalendar](http://clovis.edu/academiccalendar) for final withdrawal dates. Financial aid students should contact the Financial Aid office for information on how withdrawals may affect future financial aid. Withdrawing from a class is final and you cannot be reinstated.

## TUITION, FEES, & PAYMENT

Deadline to pay for Fall 2024 Semester is midnight on **August 9, 2024**. After that date, payment must be made the day of registration.

If payment or other financial arrangement is not made by the payment deadline, class registrations may be voided. It is the student's responsibility to drop classes through the Admissions Office if he or she does not plan to attend. Do not assume registration will automatically be voided for nonpayment. Students who are dropped for nonpayment are encouraged to re-register and make payment arrangements to secure their classes; however, your original class(es) may be closed, and you may have to choose alternate classes.

## TUITION AND FEES

Tuition charges are determined by residency status, the number of credit hours taken, and fees applicable to each course. See the following chart to calculate your tuition charges. Tuition and fees are subject to change due to legislative or Board of Trustee action.

### Miscellaneous Fees

Student Fee*	\$40
Dishonored Check*	\$25
Graduation	
Certificate/Participating*	\$50
Diploma/Participating*	\$50
Diploma/Non-Participating*	\$15
Replacement Diploma/Certificate*	\$25
Electronic Diploma/Certificate	\$5
Health and Fitness Center	
Swimming Pool Usage*	\$20
1-Day Pass*	\$5
5-Day Pass*	\$20
Hybrid Course Fee* (per course)	\$25
ID Card Replacement Fee*	\$10
Mixed Modality Fee* (per course)	\$25
Official Transcript Fee* (plus applicable shipping fees)	\$6
Online Course Fee* (per course)	\$50
Technology and Facilities Fee* (per credit hour)	\$15
Zoom Room Tech* (per credit hour)	\$4

**\*Fees are non-refundable**

Credit Hour	NM Resident In-District	NM Resident Out-of-District	Non-Resident	Senior Citizen 	Technology & Facility Fee
1	48	59	121	5	15
2	96	118	242	10	30
3	144	177	363	15	45
4	192	236	484	20	60
5	240	295	605	25	75
6	288	354	726	30	90
7	336	413	847	35	105
8	384	472	968	40	120
9	432	531	1089	45	135
10	480	590	1210	50	150
11	528	649	1331		165
12	576	708	1452		180
13-18+	576	708	1452		180
19	624	767	1573		195
Each Additional Hour	48	59	121		15

register on or after **April 9, 2024** to be eligible for the reduced rate.

## RESIDENCY STATUS FOR TUITION PURPOSES

Tuition charges are determined by your residency status. The Admissions and Records Office classifies residency status for you when your completed application is received and processed. Residency is based on the following definitions:

**Resident In-District:** Students whose legal state of residency is New Mexico, who live within the boundaries of the Clovis Community College tax district, and who have lived in New Mexico for the past 12 consecutive months.

**Resident Out-of-District:** Students whose legal state of residency is New Mexico, and who have lived in New Mexico for the past 12 consecutive months, but who live outside of the Clovis Community College tax district.

Any Texas residents who reside within a 135-mile radius of CCC will be assessed in-state, out-of-district tuition.

**Non-Resident:** Students whose legal state of residency is not New Mexico or who have not lived in New Mexico for the past 12 consecutive months.

**Petitions for In-State Tuition Classification:** You must petition for changes to your residency status by completing a Petition for Resident Tuition Classification. This form is available in the



Admissions and Records Office. All requirements must be met by **August 19, 2024** and documentation submitted to the Admissions and Records Office by **September 6, 2024**.

**Military Exemption:** Military personnel and their dependents qualify for in-state tuition rates. Contact the Admissions and Records Office at [575.769.4025](tel:575.769.4025) for assistance.

## FINANCIAL AID

Students eligible for financial aid who would like to charge their tuition and fees must set up a Pending Financial Aid Payment Plan (PFAPP), **even if their file is complete**. Students who withdraw before their financial aid checks are disbursed may lose their eligibility and may be responsible for payment of tuition, fees, books, and miscellaneous charges.

If you are using Financial Aid, please contact the Financial Aid Office prior to withdrawing. Withdrawing from a class is final and you cannot be reinstated. Contact the Admissions and Records Office at [575.769.4025](tel:575.769.4025) or email [admissions@clovis.edu](mailto:admissions@clovis.edu) if you need assistance.

Students with a PFAPP may charge books and supplies **August 10 - 30, 2024** (based on remaining eligibility).

Visit the Financial Aid Office or call [575.769.4060](tel:575.769.4060) or email [finaid@clovis.edu](mailto:finaid@clovis.edu) for more detailed information.

## SCHOLARSHIPS

CCC has many scholarships available, ranging from \$100 to \$1,000 per year. Students are encouraged to apply for scholarships to lessen the need for loans or part-time work to attend school. These scholarships are made possible by generous contributions to the College and CCC Foundation.

Apply online for dozens of CCC scholarships at [clovis.awardspring.com](http://clovis.awardspring.com).

## SENIOR CITIZEN DISCOUNT

Senior citizens may register beginning **April 9, 2024** and pay the reduced rate of \$5 per credit hour. Senior citizens who register prior to **April 9, 2024** are not eligible for the senior citizen discount. Qualifications for senior citizen discount:

- Must be 65 years of age by **August 30, 2024**
- Must be **classified as a** New Mexico resident
- Must enroll for **10 credit** hours or less during the semester

Senior citizen students must pay any course fees associated with classes. Senior citizens enrolled at CCC and who receive a reduction in tuition are entitled to all rights and privileges afforded all students.

## PAYMENT OPTIONS

**In-person:** Cash, money orders, checks (made payable to Clovis Community College), MasterCard, Visa, Discover, and American Express payments may be made at the cashier's window

across from the Bookstore.

**By phone:** Phone in credit card information to [575.769.4132](tel:575.769.4132) or [575.769.4035](tel:575.769.4035).

**Online:** Login to **Pathway** at [pathway.clovis.edu](http://pathway.clovis.edu)

- Click on the **Student Tab**
- Click on **Pay Here** with TouchNet under Registration Tools

## Third-Party Sponsor:

If a third party (i.e., employer or government agency) is paying tuition and fees on a student's behalf, either the student or the third party must provide a copy of the authorization to the cashier at the time of registration.

## Deferred Payment Plan:

CCC offers a deferred payment plan administered by TouchNet Information Solutions. To initiate payment plan, login to Pathway at [pathway.clovis.edu](http://pathway.clovis.edu). Students must have a checking or credit card account to schedule and make payments, and students must be enrolled in at least three credit hours to take advantage of the payment plan. Students should initiate the contract and make initial payment at the time of registration to confirm their registration. Students are charged a non-refundable fee of \$10 to use the deferred payment plan.

Consumer information for Clovis Community College, including our graduation rates, the median debt of students completing programs, and other important information, can be found at: [clovis.edu/consumerinfo](http://clovis.edu/consumerinfo)



WALKING/JOGGING TRACK

Trades Road

ALLIED HEALTH AND LIBRARY

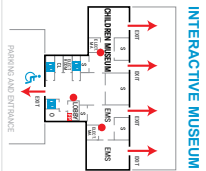

JOE AND CHARLYNE SISLER ALLIED HEALTH BUILDING

DON AND GUSTENIA BONNER NURSING EDUCATION BUILDING

DR. W. D. DABBS LIBRARY

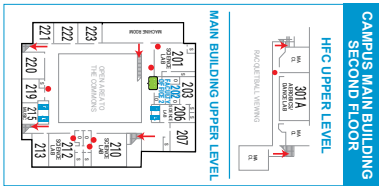
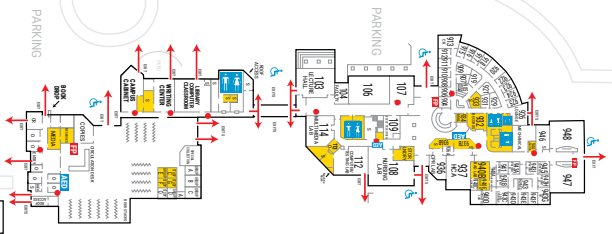

PARKING



TENNIS COURTS

PAINT BOOTH

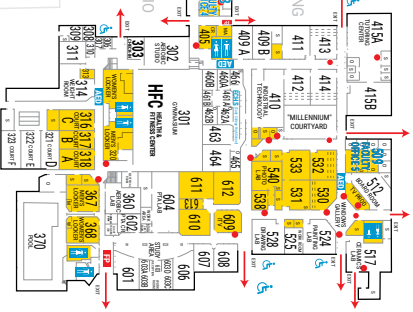

Schepps Boulevard

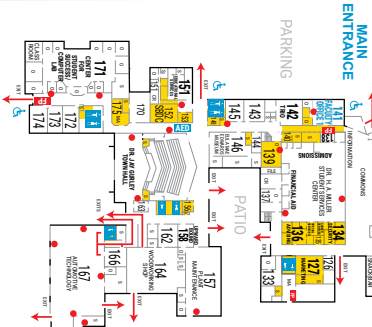

COSMETOLOGY CLINIC

CLASSROOM SOUTH

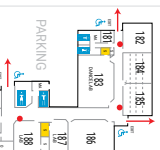

KILNHOT GLASS

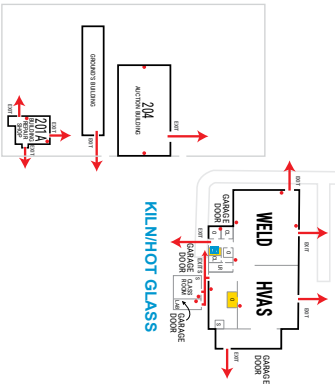

To US 60/84 - Mabry Drive



LEGEND

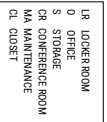



**Clovis  
Community  
College**

REGISTER ONLINE: [Clovis.edu/register](https://clovis.edu/register)

For list of course and program fees, visit [clovis.edu/fees](https://clovis.edu/fees)